

PRODUCT FEATURES:

- Retains factory features in select Dodge, Fiat, Jeep and RAM vehicles while functioning with an aftermarket radio.
- Retains Steering Wheel Controls via built-in, pre-programmed interface.
- Provides accessory power (2A Max).
- Retains factory backup camera (composite and LVDS)
- Retains factory Aux input in select vehicles.
- Retains factory Digital (Alpine amplifier) and analog amplifier.
- Retains factory SWC phone button functionality in select vehicles.
- EIA color coded wiring for easy installation.

PARTS INCLUDED:

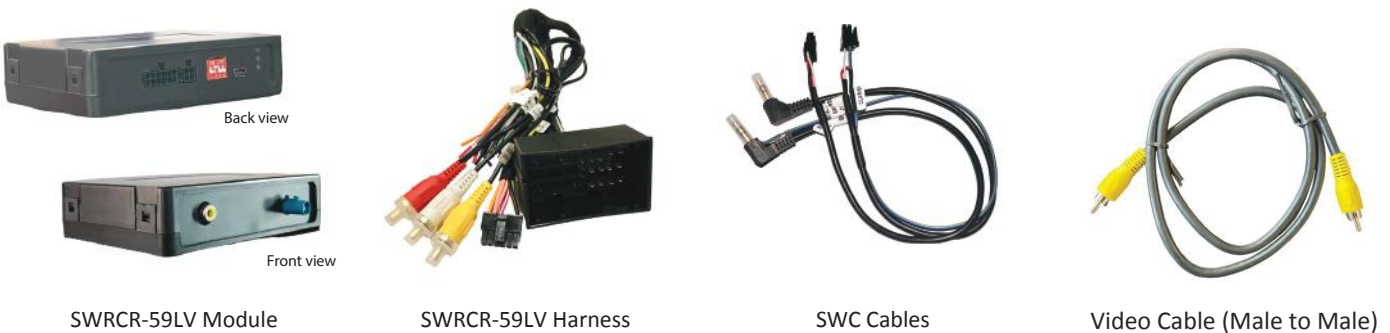

INSTALLATION DIAGRAM:

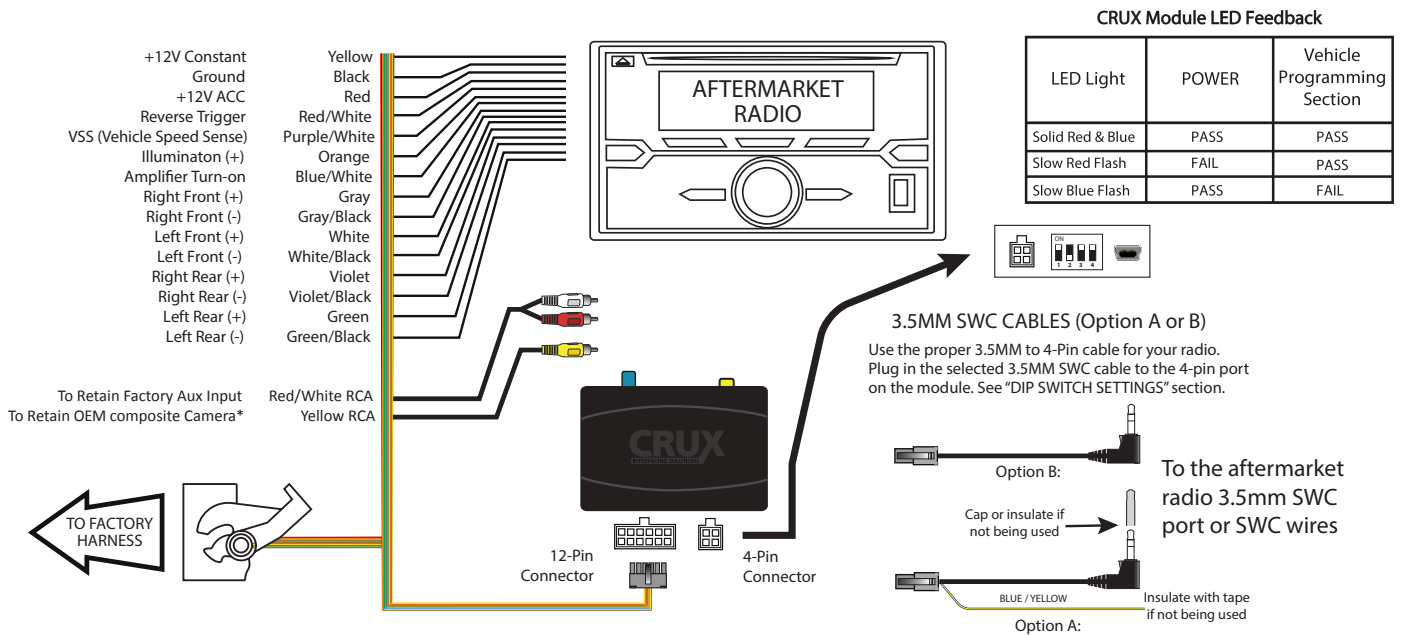

*NOTE: To Retain OEM non digital Backup Camera connect the video RCA directly to the aftermarket radio



DIGITAL CAMERA RETENTION INSTRUCTIONS:

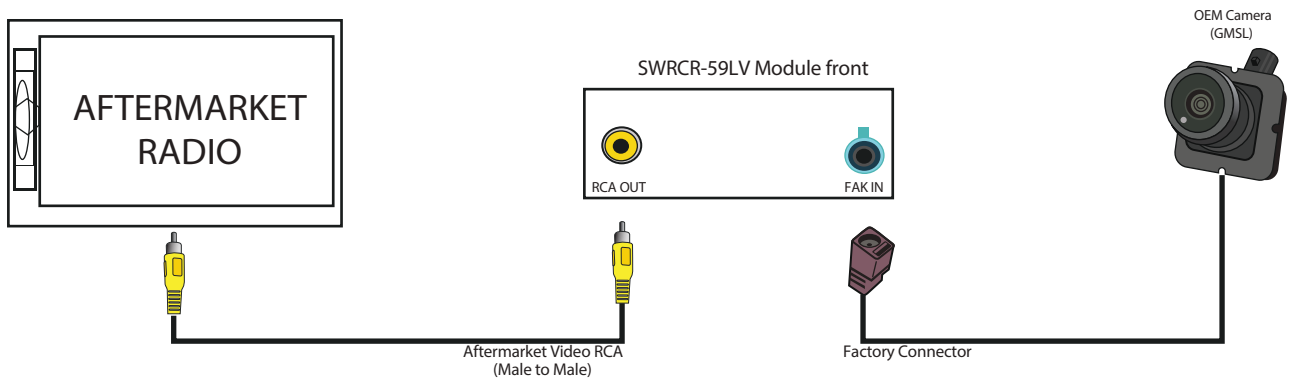

DIP SWITCH SETTINGS:

| RADIO BRAND: | DIP#: | 1 | 2 | 3 | 4* | 5* | 6* |
|---|-------|-----|-----|-----|--------|--------|--------|
| Atoto, Dual, Fahrenheit, Jensen, Nakamichi, | | OFF | ON | ON | ON/OFF | ON/OFF | ON/OFF |
| Pioneer, Power Acoustik, Soundstream | | OFF | ON | ON | ON/OFF | ON/OFF | ON/OFF |
| Blaupunkt, Most off-brand Radio | | OFF | ON | ON | ON/OFF | ON/OFF | ON/OFF |
| Alpine | | OFF | OFF | OFF | ON/OFF | ON/OFF | ON/OFF |
| Clarion | | ON | ON | OFF | ON/OFF | ON/OFF | ON/OFF |
| Kenwood | | ON | ON | ON | ON/OFF | ON/OFF | ON/OFF |
| JVC | | ON | OFF | ON | ON/OFF | ON/OFF | ON/OFF |
| Boss, Old Sony | | ON | OFF | OFF | ON/OFF | ON/OFF | ON/OFF |
| New Sony (with CarPlay) | | OFF | ON | OFF | ON/OFF | ON/OFF | ON/OFF |

SWC Troubleshoot option

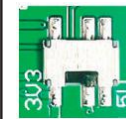

Located internally
Need to take plastic
Casing off module

If Steering Wheel Controls malfunction
please switch internal dip switch from
3v3 to 5v as shown in picture above.

Setting the DIP switches for camera type

| Camera Version* | DIP 4 | DIP 5 | DIP 6 |
|---------------------------------|-------|-------|-------|
| Small Resolution (Old Vehicles) | OFF | OFF | OFF |
| Large Resolution (New Vehicles) | ON | OFF | OFF |
| Camera Type 3 (ProMaster) | OFF | ON | OFF |

SWC MODULE DIP SWITCH



NOTE: For Atoto, Blaupunkt, Dual, Fahrenheit, Nakamichi, Power Acoustik, Soundstream, and most off-brand radios, check the aftermarket radio's manual to see if the SWC buttons need to be programmed.

After each change of the DIP switch settings you have to execute a power rest of the interface box!

Use the proper 3.5MM to 4-Pin SWC cable for the aftermarket radio that is being used. Plug the 4-pin Molex connector to the SWRCR-59D module and connect the 3.5mm plug or Blue/Yellow wire to the aftermarket radio's SWC input.

OPTION A is used for ALPINE, CLARION, (JVC and KENWOOD units will use the Blue/Yellow wire).

OPTION B is used for ATOTO, BOSS, BLAUPUNKT, DUAL, FARENHEIT, JENSEN, POWER ACOUSTIK, PIONEER, SONY, SOUNDSTREAM and most off-brand units.

NOTE: Cap or insulate the 3.5mm plug or Blue/Yellow wire if not being used.

For aftermarket radios that have wires for SWC connections, cut off the 3.5mm plug on the Crux SWC Cable (option B) and connect the SWC wires as follows:



Note that there are some radios that only have SWC1 and SWC2, in this case "shield" does not need to be connected.



VEHICLE APPLICATIONS:

DODGE

| | |
|-----------|------------|
| 2014-2016 | Dart |
| 2015-2022 | Challenger |
| 2015-2022 | Charger |
| 2014-2021 | Durango |

FIAT

| | |
|-----------|------|
| 2014-2020 | 500L |
| 2016-2020 | 500X |

JEEP

| | |
|----------------|----------------------|
| 2014-2015 | Cherokee |
| Late 2017-2020 | Compass |
| 2021-Up | Compass** |
| 2014-2015 | Grand Cherokee |
| 2015-2021 | Renegade** |
| 2022-Up | Renegade |
| 2018-2022 | Wrangler (JL model)* |
| 2020-Up | Gladiator |

RAM

| | |
|-----------|------------|
| 2013-2017 | 1500 |
| 2018-2022 | 1500* |
| 2013-2017 | 2500 |
| 2018-2021 | 2500* |
| 2013-2017 | 3500 |
| 2018-2021 | 3500* |
| 2014-2020 | ProMaster |
| 2021-2021 | ProMaster* |

Note: Applications with an () may be equipped with the OEM LVDS digital camera. Please use the module to convert the digital signal to composite to retain the factory camera.

NOTES:

New model Ram and Jeep vehicles with 32 & 12 pin connectors use part #SWRCR-59LV
 Does NOT retain Beats Audio System.

For Fiat:

- 1) Will not retain backup sensor on Fiat vehicles (if equipped).
- 2) Once Factory radio is removed, the outside temperature will no longer be present on the cluster.

For RAM ProMaster:

- 1) Will not retain Phone and Voice button.

**Some Jeep Renegade & Jeep Compass vehicles have an issue with the factory dashboard so door chimes, interior/alarm, turn signals, & hazard audible chimes do not work or are inaudible. Therefore, when you use this interface those issues will still persist. This is a factory speaker wire issue NOT SWRCR-59LV interface.



2020 Jeep Wrangler



2020 RAM 1500



SPECIALIZED SETUP FOR ALPINE STEERING WHEEL CONTROL LEARNING RADIOS

Note: Identify Alpine SWC learning radios by checking for three SWC cables and a SWC learn menu, instead of a 3.5mm SWC input.

If Interface has one SWR-100 Cable included

If Interface has two SWR Cables included

1 - Find the included SWC adapter cable.

1 - Identify appropriate SWC adapter cable.
Do not use cable with Blue / Yellow wire.

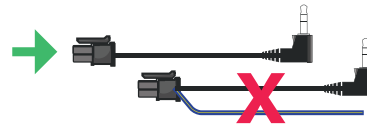

2 - Prepare the SWC Cable: Cut the SWC cable. You will find a red wire, a white wire, and a ground (shield) wire inside.



3 - Adjust the Module Settings: Set the module to the Pioneer dip switch setting. This configures the module to communicate correctly with the Alpine radio.

On Alpine iLX series radios use Pioneer settings

| | | | | |
|------|-----|-----|----|----|
| DIP: | 1 | 2 | 3 | 4 |
| | OFF | OFF | ON | ON |

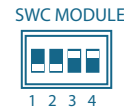

4 - Configure the Alpine Radio: On your Alpine radio, select the setting that includes an adapter for SWC. This ensures the radio will recognize the steering wheel controls.

Select "SWC Adapter"



Select the setting "With Adapter"

5 - Connect the Wires: Connect both the SWC1 and SWC2 wires from aftermarket radio to the red wire from our SWC cable. Connect the SWC ground wire to the shield (ground) wire of our SWC cable. These steps should enable the steering wheel controls on your Alpine iLX series radio.

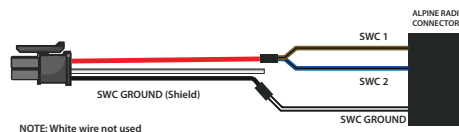
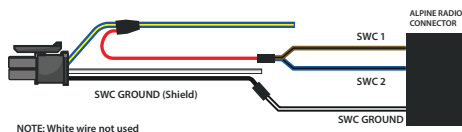

6. Program the SWC: Navigate to the SWC settings on your Alpine radio to assign and test each control function.

